

# UCQ2

## 薄型鋁合金氣缸

### UCQ2 THIN-TYPE PNEUMATIC CYLINDER



#### 產品特性 FEATURES

氣缸內徑 (mm)	Φ12	Φ16	Φ20	Φ25	Φ32	Φ40	Φ50	Φ63	Φ80	Φ100
標準行程 (mm)	5, 10, 15, 20, 25, 30, 35, 40, 45, 50									
行程範圍 (mm)	Max:30		Max:50							
使用溫度範圍 (°C)	-10 ~ +60 °C									

最大操作壓力: 10 kgf/cm<sup>2</sup>  
 最小操作壓力: 1 kgf/cm<sup>2</sup>

Max. operating pressure: 10 kgf/cm<sup>2</sup>  
 Min. operating pressure: 1 kgf/cm<sup>2</sup>

#### 注意事項

UCQ2系列可附磁性感應 (單動不附磁性感應)  
 行程在50mm以上屬於特殊定製

#### NOTE

Magnetic piston(optional).  
 Stroke in more than 50 mm belongs to special custom.

#### 單雙動氣缸 DOUBLE-SINGLE ACTING CYLINDERS

單動常入型 (壓回) Single acting-normally retracted piston rod type	UCQ2...S	
單動常出型 (壓出) Single acting-normally extended piston rod type	UCQ2...T	
雙動單軸標準型 Double acting-single end rod type	UCQ2...	
雙動單軸型附磁性感應 Double acting-single end rod type(piston with magnet)	UCDQ2...	
雙動雙軸型 Double acting-double end rod type	UCQ2W...	
雙動雙軸型附磁性感應 Double acting-double end rod type(piston with magnet)	UCDQ2W...	

#### 訂購標示法 ORDERING INDICATION

示例: UCDQ2WB20-10-SMDA73\*2

UC	系列 Series	UC	
D	磁性感應 Magnetic	無:無附磁性感應 D:內附磁性感應 Nil: No magnet D: With magnet	
Q2W	活塞桿 Piston rod	Q2:單軸 Q2: Single end rod	Q2W:雙軸 Q2W: Double end rod
B	安裝方法 Mounting method	A:兩端內螺紋 A:Female thread	B:通孔(標準) B:Hole
20	氣缸內徑 Cylinder inside diameter	Φ12, Φ16, Φ20, Φ25, Φ32, Φ40, Φ50, Φ63, Φ80, Φ100	
10	行程 Stroke	5, 10, 15, 20, 25, 30, 35, 40, 45, 50	
S	動作型式 Acting	無: 雙動 S: 單動 (壓回) T: 單動 (壓出)	Nil: Double acting S: Single acting(Retracted) T: Single acting(Extended)
M	軸端型式 Rod end	無: 內牙 M: 外牙	Nil: Female M: Male
D-A73	近接開關 Rod end	D-A72:AC220V 5-10mA	D-A73:DC24V 5-40mA AC100V 5-20mA
2	數量 Quantity	1:1pcs	2:2pcs

使用流體: 過濾之乾燥壓縮空氣 Usable fluid: Oiled Dry Clean Compressed Air

#### 兩端內螺紋



#### UCQ2A / UCDQ2A

Unit:mm

缸徑 BORE	12	16	20	25	32	40	50	63	80	100
O	M4×0.7	M4×0.7	M6×1.0	M6×1.0	M6×1.0	M6×1.0	M8×1.25	M10×1.5	M12×1.75	M12×1.75
R	7	7	10	10	10	10	14	18	22	22

#### 桿端外螺紋

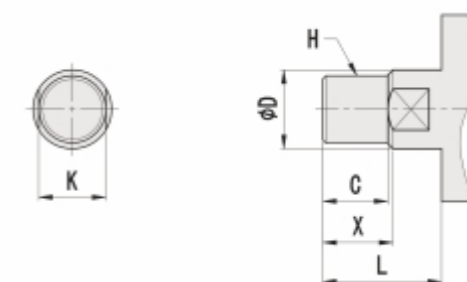

Unit:mm

缸徑 BORE	12	16	20	25	32	40	50	63	80	100
C	9	10	12	15	20.5	20.5	26	26	32.5	32.5
X	10.5	12	14	17.5	23.5	23.5	28.5	28.5	35.5	35.5
ΦD	6	8	10	12	16	16	20	20	25	30
H	M5×0.8	M6×1.0	M8×1.25	M10×1.25	M14×1.5	M14×1.5	M18×1.5	M18×1.5	M22×1.5	M26×1.5
L	14	15.5	18.5	22.5	28.5	28.5	33.5	33.5	43.5	43.5
K	5	6	8	10	14	14	17	17	22	27

UCQ2B/UCDQ2B TYPE

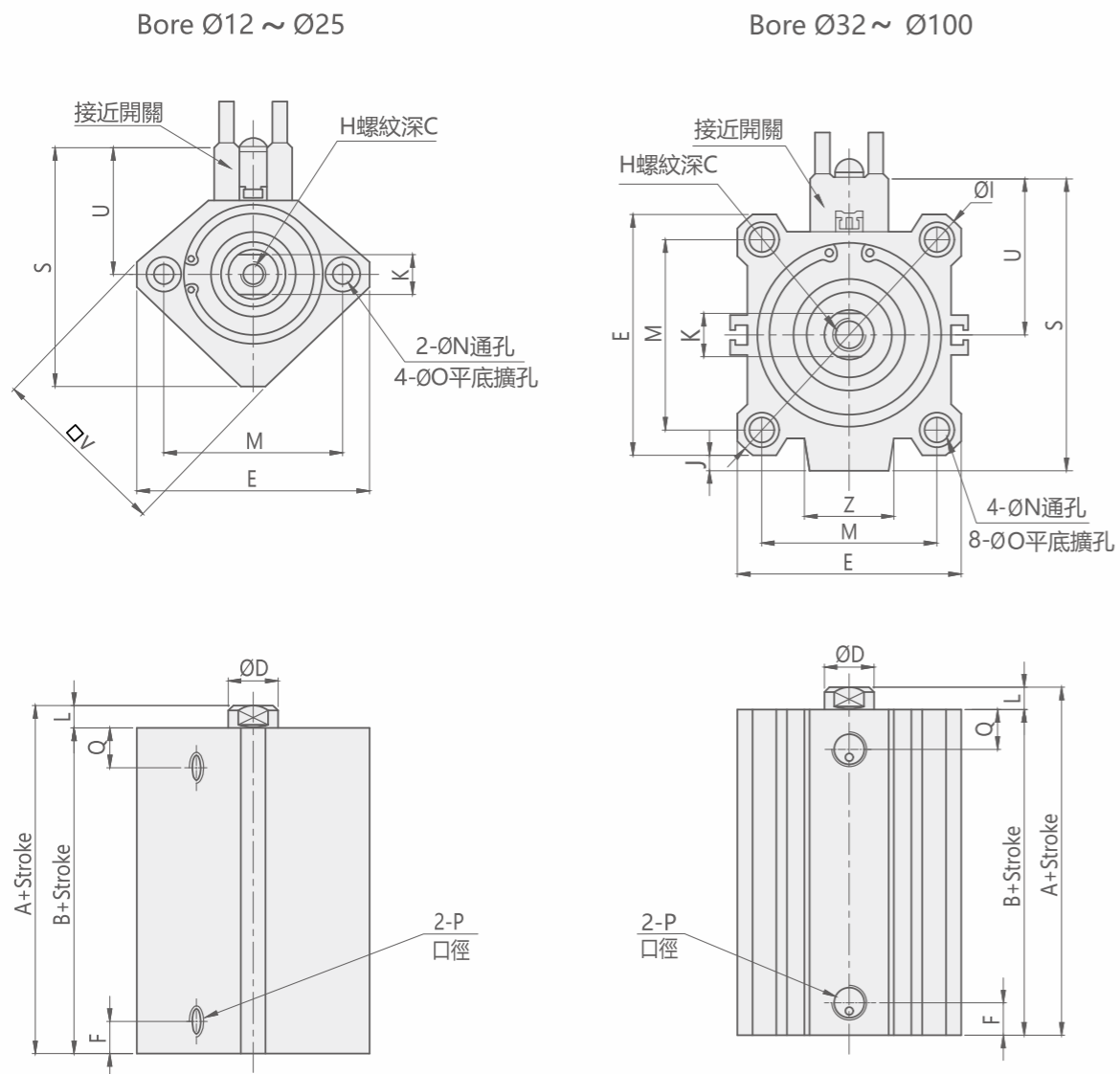

UCQ2B...S TYPE  
UCQ2A...S TYPE

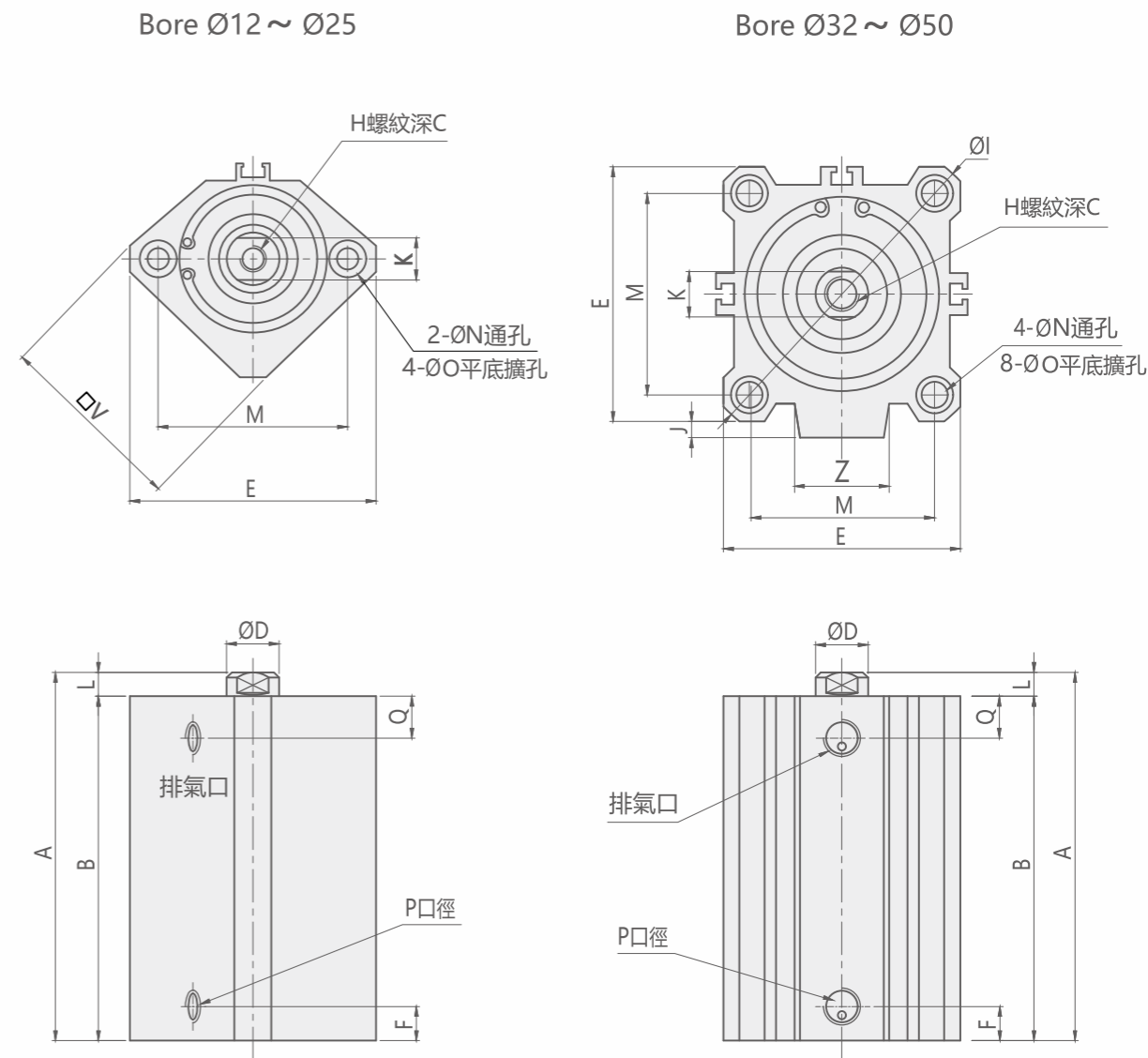

Unit:mm

缸徑 DIAMETER	行程範圍 (mm)	A	A*	B	B*	ΦD	E	F	F*	H	C	I	J	K	L	M	ΦN	ΦO	P	P*	Q	Q*	S	U	V	Z
12	5-30	20.5	31.5	17	28	Φ6	32	6	6	M3×0.5	6	-	-	5	3.5	22	Φ3.5	Φ6.5深3.5	M5×0.8	M5×0.8	6.5	6.5	35.5	19.5	25	-
16	5-30	22	34	18.5	30.5	Φ8	38	6.5	6.5	M4×0.7	8	-	-	6	3.5	28	Φ3.5	Φ6.5深3.5	M5×0.8	M5×0.8	7	7	41.5	22.5	29	-
20	5-50	24	36	19.5	31.5	Φ10	46.8	6.5	6.5	M5×0.8	7	-	-	8	4.5	36	Φ5.5	Φ9深7	M5×0.8	M5×0.8	8	8	48	24.5	36	-
25	5-50	27.5	37.5	22.5	32.5	Φ12	52	7	7	M6×1.0	12	-	-	10	5	40	Φ5.5	Φ9深7	M5×0.8	M5×0.8	10	10	53.5	27.5	40	-
32	5 10-50	30	40	23	33	Φ16	45	8	8	M8×1.25	13	60	4.5	14	7	34	Φ5.5	Φ9深7	M5×0.8 G1/8	G1/8	9.5	9.5	58.5	31.5	-	18
40	5-50	36.5	46.5	29.5	39.5	Φ16	52	9	9	M8×1.25	13	69	5	14	7	40	Φ5.5	Φ9深7	G1/8	G1/8	10.5	10.5	66	35	-	18
50	10-50	38.5	48.5	30.5	40.5	Φ20	64	11	11	M10×1.5	15	86	7	17	8	50	Φ6.6	Φ11深8	G1/4	G1/4	11	11	80	41	-	22
63	10-50	44	54	36	46	Φ20	77	11.5	11.5	M10×1.5	15	103	7	17	8	60	Φ9	Φ14深10.5	G1/4	G1/4	15	15	93	47.5	-	22
80	10-50	53.5	63.5	43.5	53.5	Φ25	98	14	14	M16×2.0	21	132	6	22	10	77	Φ11	Φ17.5深13.5	G3/8	G3/8	15	15	112.5	57.5	-	26
100	10-50	65	75	53	63	Φ30	117	16.5	16.5	M20×2.5	27	156	6.5	27	12	94	Φ11	Φ17.5深13.5	G3/8	G3/8	22	22	132.5	67.5	-	26

註：帶「\*」號為磁性氣缸尺寸 Remark: With 「\*」 mark is for magnetic cylinder dimensions.

Unit:mm

缸徑 DIAMETER	A			B			ΦD	E	F	H	C	ΦI	J	K	L	M	ΦN	ΦO	P			Q		V	Z	
	5st	10st	20st	5st	10st	20st													5st	10st	20st	5st	10st			
12	25.5	30.5	-	22	27	-	Φ6	32	6	6	M3×0.5	6	-	-	5	3.5	22	Φ3.5	Φ6.5深3.5	M5×0.8	M5×0.8	-	6.5	6.5	25	-
16	27	32	-	23.5	28.5	-	Φ8	38	6.5	6.5	M4×0.7	8	-	-	6	3.5	28	Φ3.5	Φ6.5深3.5	M5×0.8	M5×0.8	-	7	7	29	-
20	29	34	-	24.5	29.5	-	Φ10	46.8	6.5	6.5	M5×0.8	9	-	-	8	4.5	36	Φ5.5	Φ9深7	M5×0.8	M5×0.8	-	8	8	36	-
25	32.5	37.5	-	27.5	32.5	-	Φ12	52	7	7	M6×1.0	12	-	-	10	5	40	Φ5.5	Φ9深7	M5×0.8	M5×0.8	-	10	10	40	-
32	35	40	-	28	33	-	Φ16	45	8	8	M8×1.25	13	Φ60	4.5	14	7	34	Φ5.5	Φ9深7	M5×0.8	G1/8	-	9.5	9.5	-	18
40	41.5	46.5	-	34.5	39.5	-	Φ16	52	9	9	M8×1.25	13	Φ69	5	14	7	40	Φ5.5	Φ9深7	G1/8	G1/8	-	10.5	10.5	-	18
50	-	48.5	58.5	-	40.5	50.5	Φ20	64	11	11	M10×1.5	15	Φ86	7	17	8	50	Φ6.6	Φ11深8	-	G1/4	G1/4	11	11	-	22

註：以上A及B的尺寸已包含行程長度 Remark: Above A and B size contains stroke length.

UCQ2B...T TYPE  
UCQ2A...T TYPE

Bore Ø12 ~ Ø25

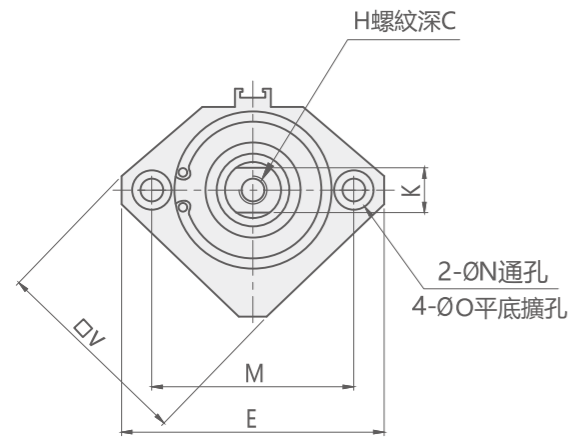

Bore Ø32 ~ Ø50

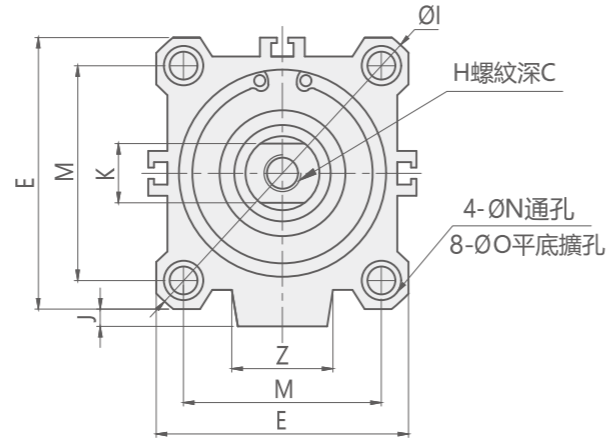

UCQ2W...B.../UCDQ2W...B...TYPE  
UCQ2W...A.../UCDQ2W...A...TYPE

Bore Ø12 ~ Ø25

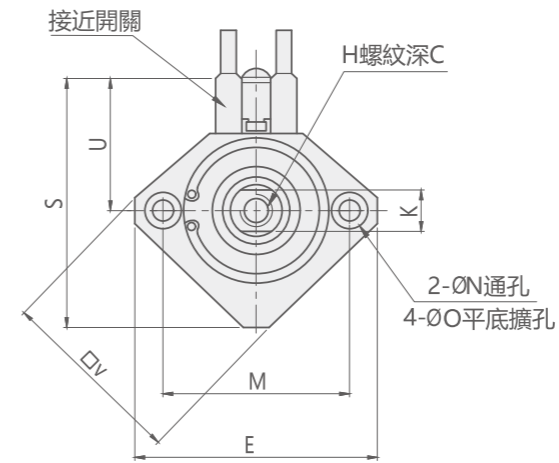

Bore Ø32 ~ Ø100

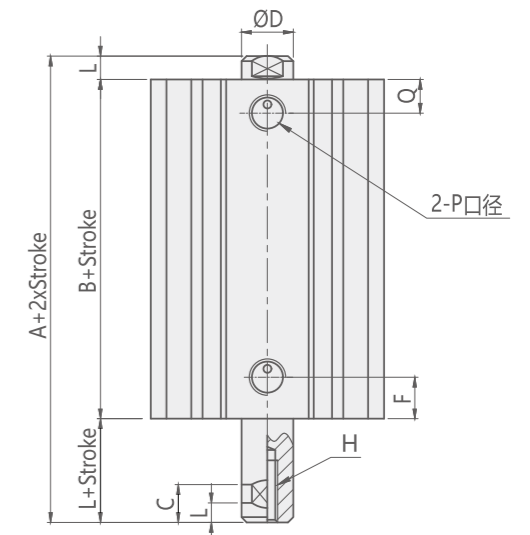
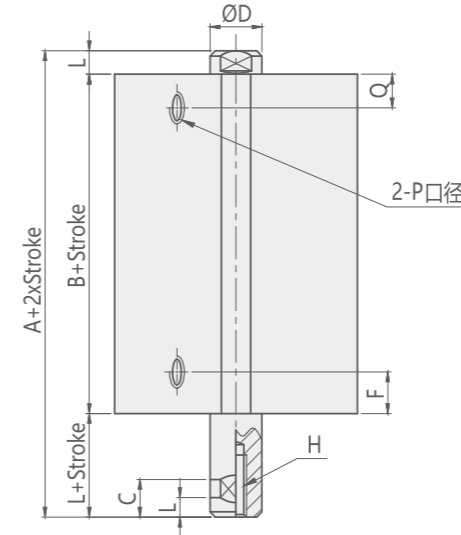
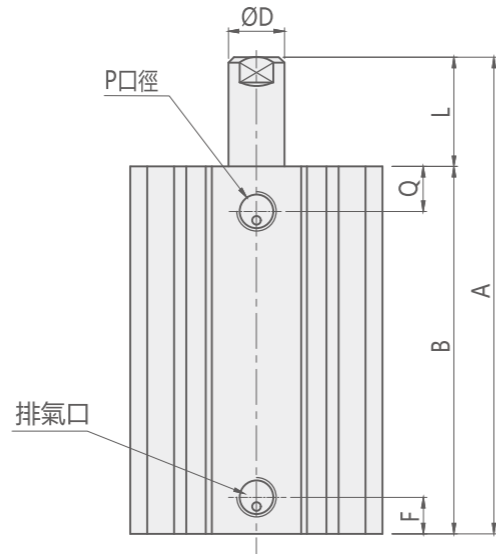
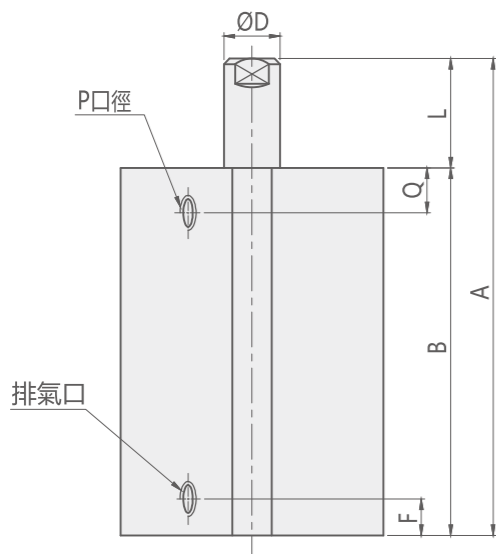
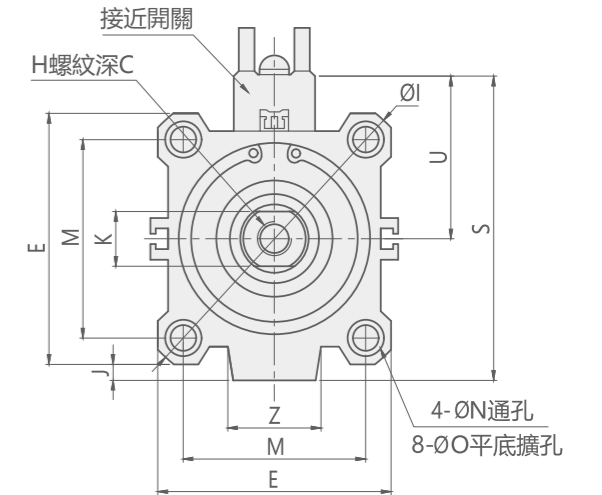

Unit:mm

缸徑 DIAMETER	A			B			ΦD	E	F	H	C	ΦI	J	K	L			M	N	ΦO	P			Q		V	Z	
	5st	10st	20st	5st	10st	20st									5st	10st	20st				5st	10st	20st	5st	10st			20st
12	30.5	40.5	-	22	27	-	Φ6	32	7	7	M3×0.5	6	-	-	5	8.5	13.5	-	22	3.5	Φ6.5深3.5	M5×0.8	M5×0.8	-	6.5	6.5	25	-
16	32	42	-	23.5	28.5	-	Φ8	38	6.5	6.5	M4×0.7	8	-	-	6	8.5	13.5	-	28	3.5	Φ6.5深3.5	M5×0.8	M5×0.8	-	7	7	29	-
20	34	44	-	24.5	29.5	-	Φ10	46.8	6.5	6.5	M5×0.8	9	-	-	8	9.5	14.5	-	36	5.5	Φ9深7	M5×0.8	M5×0.8	-	8	8	36	-
25	37.5	47.5	-	27.5	32.5	-	Φ12	52	7	7	M6×1.0	12	-	-	10	10	15	-	40	5.5	Φ9深7	M5×0.8	M5×0.8	-	10	10	40	-
32	40	50	-	28	33	-	Φ16	45	8	8	M8×1.25	13	Φ60	4.5	14	12	17	-	34	5.5	Φ9深7	M5×0.8	G1/8	-	9.5	9.5	-	18
40	46.5	56.5	-	34.5	39.5	-	Φ16	52	9	9	M8×1.25	13	Φ69	5	14	12	17	-	40	5.5	Φ9深7	G1/8	G1/8	-	10.5	10.5	-	18
50	-	58.5	78.5	-	40.5	50.5	Φ20	64	11	11	M10×1.5	15	Φ86	7	17	-	18	28	50	6.6	Φ11深8	-	G1/4	G1/4	11	11	-	22

註：以上A及B的尺寸已包含行程長度 Remark: Above A and B size contains stroke length.

Unit:mm

缸徑 DIAMETER (mm)	行程範圍	A	A*	B	B*	ΦD	E	F	F*	H	C	ΦI	J	K	L	M	ΦN	ΦO	P	P*	Q	Q*	S	U	V	Z
12	5-30	32.2	39.4	25.5	32.4	Φ6	32	6.5	6.5	M3×0.5	6	-	-	5	3.5	22	Φ3.5	Φ6.5深3.5	M5×0.8	M5×0.8	6.5	6.5	35.5	19.5	25	-
16	5-30	33	43	26	36	Φ8	38	7	7	M4×0.7	8	-	-	6	3.5	28	Φ3.5	Φ6.5深3.5	M5×0.8	M5×0.8	7	7	41.5	22.5	29	-
20	5-50	35	47	26	38	Φ10	46.8	8	8	M5×0.8	9	-	-	8	4.5	36	Φ5.5	Φ9深7	M5×0.8	M5×0.8	8	8	48	24.5	36	-
25	5-50	39	49	29	39	Φ12	52	10	10	M6×1.0	12	-	-	10	5	40	Φ5.5	Φ9深7	M5×0.8	M5×0.8	10	10	53.5	27.5	40	-
32	5 10-50	44.5	54.5	30.5	40.5	Φ16	45	9.5	9.5	M8×1.25	13	Φ60	4.5	14	7	34	Φ5.5	Φ9深7	M5×0.8 G1/8	G1/8	9.5	9.5	58.5	31.5	-	18
40	5-50	54	64	40	50	Φ16	52	10.5	10.5	M8×1.25	13	Φ69	5	14	7	40	Φ5.5	Φ9深7	G1/8	G1/8	10.5	10.5	66	35	-	18
50	10-50	56.5	66.5	40.5	50.5	Φ20	64	11	11	M10×1.5	15	Φ86	7	17	8	50	Φ6.6	Φ11深8	G1/4	G1/4	11	11	80	41	-	22
63	10-50	58	68	42	52	Φ20	77	15	15	M10×1.5	15	Φ103	7	17	8	60	Φ9	Φ14深10.5	G1/4	G1/4	15	15	93	47.5	-	22
80	10-50	71	81	51	61	Φ25	98	15	15	M16×2.0	21	Φ132	6	22	10	77	Φ11	Φ17.5深13.5	G3/8	G3/8	15	15	112.5	57.5	-	26
100	10-50	84.5	94.5	60.5	70.5	Φ30	117	22	22	M20×2.5	27	Φ156	6.5	27	12	94	Φ11	Φ17.5深13.5	G3/8	G3/8	22	22	132.5	67.5	-	26

註：帶「\*」號為磁性氣缸尺寸 Remark: With「\*」mark is for magnetic cylinder dimensions.